



# GM GOVIANU

## SESHADRIPURAM



CONTACT : - +91 8088 330 330

WEBSITE : [www.govianu.com](http://www.govianu.com)

EMAIL : [Info@govianu.com](mailto:Info@govianu.com)



---

# **EXCLUSIVE LIFESTYLE, ELITE NEIGHBOURHOODS, SUPREME CONSTRUCTION QUALITY**

---



GOVIANU has emerged as one of the most respected general contracting firms in the area of commercial and private constructions. The company has already proven its ability to take on large complex projects and complete them on time, on budget and at the highest level of quality. Over the last decade, the Govianu Group has firmly established itself as one of the leading developers of real estate in Bangalore by imprinting its indelible mark across all asset classes.

Founded in 2010, with the spirit of innovation at its core, GOVIANU always strives for quality, customer focus, robust engineering, uncompromising business ethics and steadfast commitment to timeless values and total transparency in every aspect of its business. These exceptional attributes have made Govianu progress consistently. The company already has several successful completed and ongoing projects in Bangalore, Mysore, Chikmagalur and Tumkur to its credit, and currently has one million sq. ft. under various stages of construction in residential, commercial and hospitality sectors. Innovation in our offerings combined with an emphasis on contemporary architecture, strong project execution and quality construction have helped us transform into a respectful brand that contributes to the fine art of living.



# GM GOVIANU

GM Govianu at Seshadripuram is a posh commercial and residential hub nestled in the heart of the city. An elite neighbourhood, sprawling living spaces, view of the Golf Course and luxurious amenities that match your lifestyle - Matching every expectation, this is the life at 'GM Govianu'.

GM Govianu hosts meticulously designed homes with state-of-the-art architecture ensuring maximum natural light, well-ventilated, extensive rooms, lavish balconies which add to your grand living experience. With each flat being a corner property, you get the best views of Bengaluru's urban landscape from home. Carefully crafted with premium specifications, the limited edition homes create a sanctum of style and class.

GM Govianu is very conveniently located in Central Bangalore, offering excellent connectivity to the entire city. Popular shopping malls, hospitals, public transportation, and education centers are in close proximity to the property.

Carve your own personal getaway at GM Govianu. Energize at the state-of-the-art gym or revel in pool-side parties; leisure moments will always be special. With modern amenities, modern security systems and spacious basement parking, we have taken utmost care to ensure your retreat is as exclusive as your lifestyle.







## PROJECT HIGHLIGHTS

- » NUMBER OF FLOORS : PARKING + 8
- » NUMBER OF FLATS : 25
- » ONLY 5 FLAT PER FLOOR
- » 1 CAR PARKING PER UNIT
- » 100% VAASTU COMPLAINT
- » LAVISH SIZE ROOMS
- » TEAK WOOD MAIN DOORS
- » SPACIOUS BALCONIES
- » PREMIUM MATERIALS AND HIGH- END FINISHES.
- » COVERED CAR PARK
- » LED LIGHTING FIXTURES
- » GROHE SANITARY FIXTURES

## AMENITIES



24X7 100% POWER BACKUP



LUSH GREEN ENVIRONMENT WITH MANICURED GARDEN



24X7 CCTV SURVEILLANCE



ROUND THE CLOCK SECURITY



WELL EQUIPPED GYMNASIUM



SWIMMING POOL



24X7 WATER SUPPLY CAUVERY AND BOREWELL





- |                                 |                                |
|---------------------------------|--------------------------------|
| 1. FOYER<br>6'6" X 7'9"         | 8. BALCONY B<br>4'0" X 11'3"   |
| 2. LIVING ROOM<br>19'3" X 12'3" | 9. C. TOILET<br>8'0" X 4'6"    |
| 3. DINING<br>13'9" X 10'0"      | 10. BEDROOM 2<br>11'3" X 13'0" |
| 4. KITCHEN<br>9'9" X 9'9"       | 11. A. TOILET 2<br>4'6" X 8'0" |
| 5. UTILITY<br>8'0" X 4'6"       | 12. M.BEDROOM<br>13'4" X 13'9" |
| 6. BALCONY A<br>6'3" X 10'0"    | 13. M.TOILET<br>8'0" X 5'0"    |
| 7. BEDROOM 1<br>11'9" X 11'3"   | 14. BALCONY C<br>25'0" X 4'9"  |



## UNIT 1





- |                                 |                                |
|---------------------------------|--------------------------------|
| 1. FOYER<br>5'8" X 7'6"         | 8. BALCONY B<br>11'3" X 6'6"   |
| 2. LIVING ROOM<br>20'6" X 14'0" | 9. A. TOILET 2<br>5'8" X 6'0"  |
| 3. DINING<br>12'6" X 10'0"      | 10. BEDROOM 3<br>11'8" X 12'   |
| 4. KITCHEN<br>12'0" X 8'6"      | 11. C.TOILET<br>8'8" X 5'0"    |
| 5. UTILITY<br>5'6" X 8'6"       | 12. M.BEDROOM<br>14'0" X 13'3" |
| 6. BALCONY A<br>5'6" X 10'0"    | 13. M. TOILET<br>6'6" X 6'4"   |
| 7. BEDROOM 2<br>11'9" X 12'0"   | 14. BALCONY C<br>11'0" X 5'0"  |



## UNIT 2

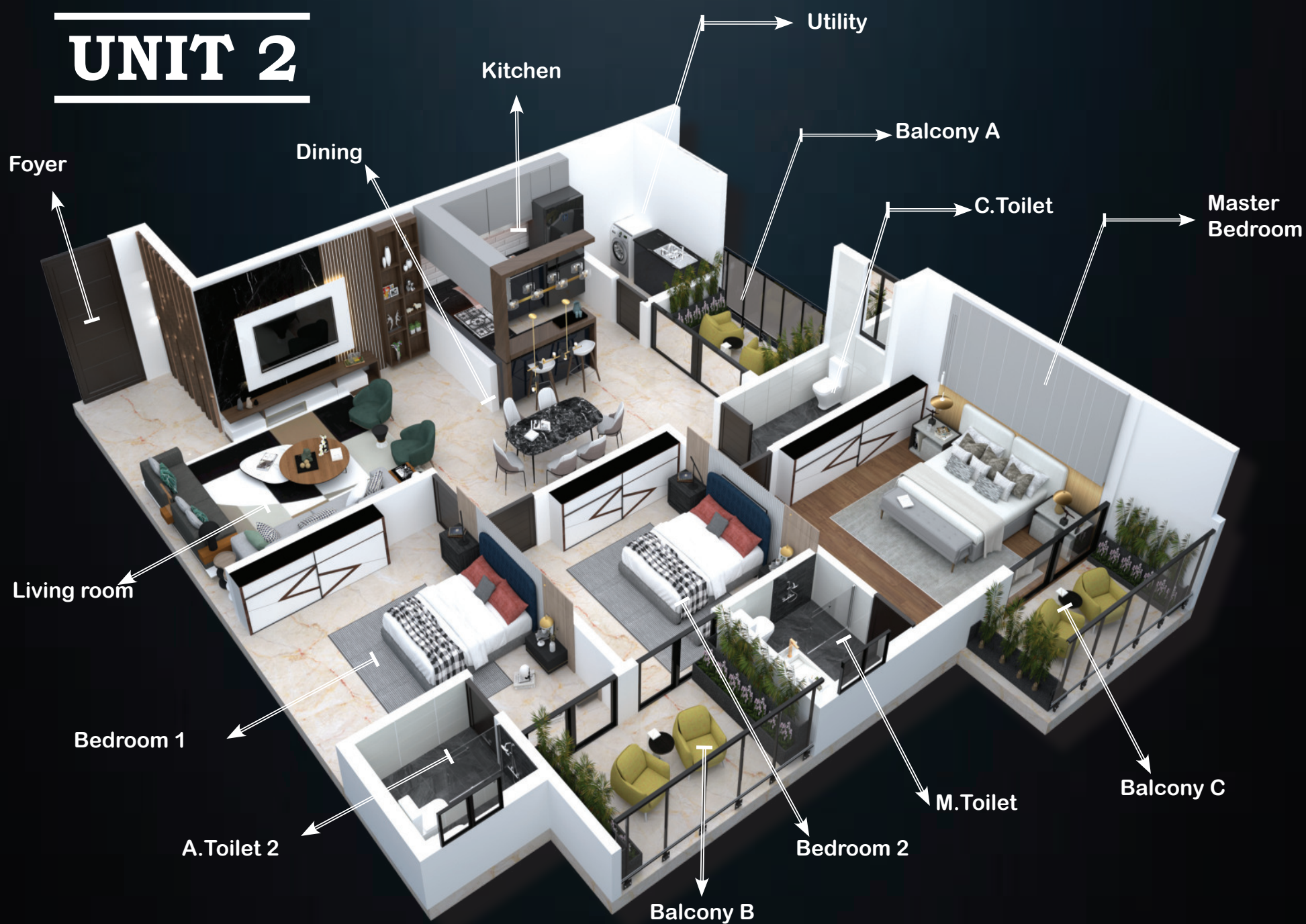





- |                                 |                                |
|---------------------------------|--------------------------------|
| 1. FOYER<br>7'0" X 5'8"         | 9. C. TOILET<br>6'0" X 6'0"    |
| 2. LIVING ROOM<br>16'0" X 15'6" | 10. BEDROOM 2<br>10'9" X 13'6" |
| 3. DINING<br>11'6" X 10'0"      | 11. A.TOILET 2<br>7'0" X 5'9"  |
| 4. KITCHEN<br>9'4" X 7'8"       | 12. BALCONY C<br>6'6" X 6'6"   |
| 5. UTILITY<br>8'9" X 4'4"       | 13. M.BEDROOM<br>15'0" X 12'3" |
| 6. BALCONY A<br>7'0" X 10'0"    | 14. WARDROBE<br>7'3" X 7'0"    |
| 7. BEDROOM 3<br>13'6" X 10'8"   | 15. M.TOILET<br>6'0" X 7'0"    |
| 8. BALCONY B<br>5'0" X 11'3"    | 16. BALCONY D<br>5'0" X 12'3"  |

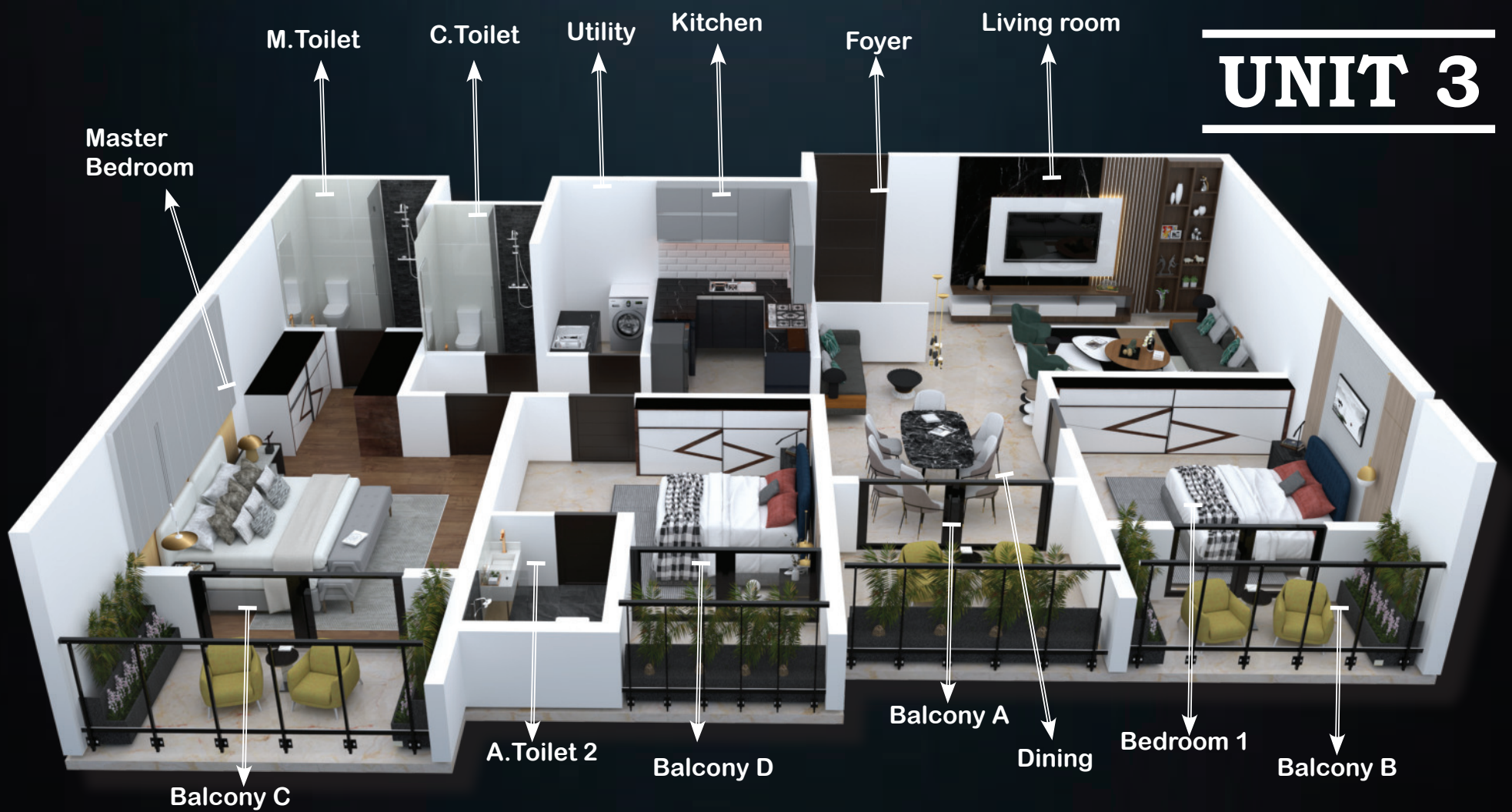





- |                                 |                                |
|---------------------------------|--------------------------------|
| 1. FOYER<br>6'6" X 6'0"         | 9. A.TOILET 2<br>8'6" X 4'6"   |
| 2. LIVING ROOM<br>14'3" X 16'0" | 10. BEDROOM 3<br>11'4" X 13'6" |
| 3. DINING<br>13'0" X 12'0"      | 11. BALCONY B<br>11'4" X 4'6"  |
| 4. BALCONY A<br>6'6" X 12'0"    | 12. M.BEDROOM<br>13'6" X 13'0" |
| 5. KITCHEN<br>9'6" X 11'0"      | 13. WARDROBE<br>6'6" X 6'3"    |
| 6. UTILITY<br>4'0" X 11'0"      | 14. M.TOILET<br>8'6" X 5'4"    |
| 7. C. TOILET<br>5'0" X 7'6"     | 15. SHOWER AREA<br>4'9" X 3'6" |
| 8. BEDROOM 2<br>12' 3" X 12'4"  | 16. BALCONY C<br>4'9" X 8'3"   |



## UNIT 4





- |                                 |                                |
|---------------------------------|--------------------------------|
| 1. FOYER<br>6'0" X 12'0"        | 10. BEDROOM 4<br>11'9" X 10'0" |
| 2. LIVING ROOM<br>20'8" X 17'0" | 11. C. TOILET<br>8'0" X 5'0"   |
| 3. DINING<br>13'0" X 17'0"      | 12. BALCONY A<br>8'0" X 11'6"  |
| 4. KITCHEN<br>11'8" X 10'0"     | 13. BEDROOM 2<br>11'3" X 12'9" |
| 5. UTILITY<br>8'0" X 4'6"       | 14. A. TOILET 2<br>8'6" X 5'0" |
| 6. M. BEDROOM<br>15'6" X 12'0"  | 15. BALCONY C<br>11'6" X 5'6"  |
| 7. WARDROBE<br>6'6" X 7'0"      | 16. BEDROOM 3<br>10'9" X 12'9" |
| 8. M. TOILET<br>5'4" X 7'0"     | 17. A. TOILET 3<br>4'6" X 8'6" |
| 9. BALCONY B<br>5'6" X 11'4"    |                                |



## UNIT 5

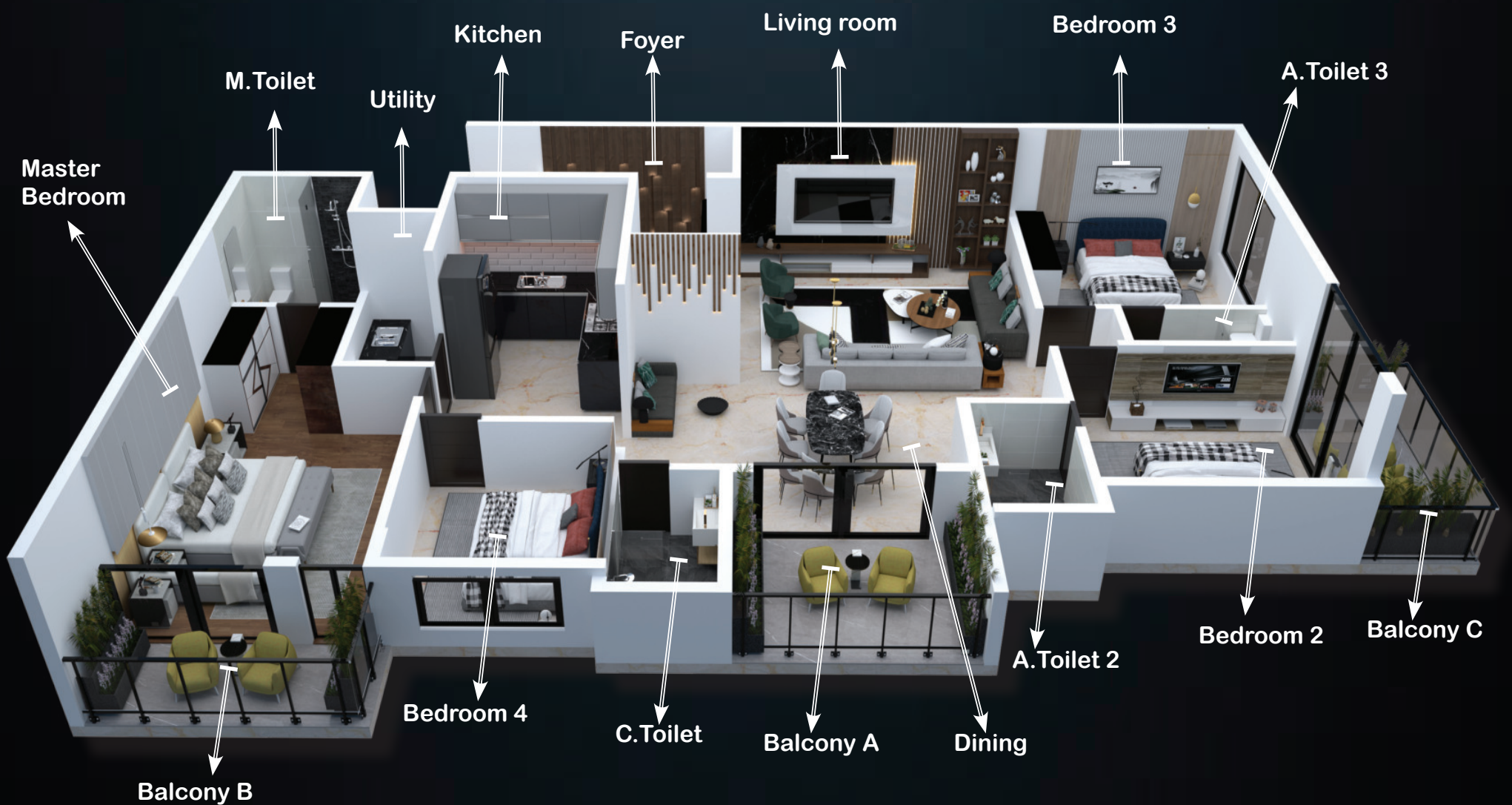



## TRANSPORT

Majestic Bus Stop -14min

Vidhana Soudha Metro - 7min

Bangalore Cant Railway Station -7min

Kempegowda International Airport -45min

## SHOPPING AND ENTERTAINMENT

Sigma Central Mall-5min

Fun Cinemas- 5min

Mantri Mall - 5min

Orion Mall -25min

## IT HUBS

Global Vision- 5min

Accenture - 28min

L & T Tech Park-30min

ManyataTech Park- 30min

## HEALTH CARE

Fortis Hospital -3min

Manipal Hospital - 5min

Al Ameen Hospital- 5min

Columbia Asia  
Hospital- 30min

## GM GOVIANU SESHADRIPURAM

## NEAR BY LAND MARKS

Race Course -5 min

Bengaluru Palace -5min

Bengaluru Golf Club-5min

Vidhana Soudha-6 min

Cubbon Park -5 min

Visvesvaraya  
Museum -5min

Army Public School -11min

UB city -7 min







JUDICIAL LAYOUT,  
BENGALURU

GOVIANU MADRE DIVINA



YELAHANKA,  
BENGALURU

GOVIANU PARKVIEW



SAHAKARNAGAR,  
BENGALURU

GOVIANU JODIDHAR ATLANTIS



MALLESHARAM,  
BENGALURU

GOVIANU MARGOSA



CUNNINGHAM ROAD,  
BENGALURU

GOVIANU CUNNINGHAM



DOLLAR'S COLONY,  
BENGALURU

GOVIANU BOUGAINVILLA



ITTIGE GUDU,  
MYSORE

GOVIANU GURIKAR LUXURIA



YELAHANKA,  
BENGALURU

GOVIANU SANGAM



SANJAY NAGAR,  
BENGALURU

GOVIANU SUBHRAM

# GOVIANU



DOLLAR'S COLONY,  
BENGALURU

GOVIANU PANTHEON



VIJAYANAGAR,  
BENGALURU

GOVIANU NAKSHATHRA



JOLDHAL,  
CHIKMAGULUR

GOVIANU CHIKMAGULUR RESORT



SANJAY NAGAR,  
BENGALURU

GOVIANU SWATHI



BENSON TOWN,  
BENGALURU

GOVIANU BENSON



BENSON TOWN,  
BENGALURU

GOVIANU GRACE GARDEN



YESHWANTPUR,  
BENGALURU

GOVIANU ACE GRAND



MAHALAKSHMI LAYOUT,  
BENGALURU

GOVIANU CRESCENT



HSR LAYOUT,  
BENGALURU

GOVIANU HSR





# GM GOVIANU

## SESHADRIPURAM



CONTACT : - +91 8088 330 330

WEBSITE : [www.govianu.com](http://www.govianu.com)

EMAIL : [Info@govianu.com](mailto:Info@govianu.com)